

SP-1 senior phone

USER MANUAL

This user manual is based on 2017.04 software version. After upgrading, features may change!

Preface

Thank you for choosing a WayteQ product!

Please read this manual carefully before using the wall charger as it contains some important information. And if you have trouble understanding and follow the instructions listed in this manual, please contact our customer support team at info@wayteq.eu.

Safety precautions

To prevent injury to yourself and others or damage to your device, read all of the following information before using your device.

- Do not use damaged power cords or plugs, or loose electrical sockets
- Do not touch the power cord with wet hands, or disconnect the charger by pulling on the cord
- Do not bend or damage the power cord
- Do not use your device while charging or touch your device with wet hands
- Do not short-circuit the charger or the battery
- Do not drop or cause an impact to the charger or the battery
- Do not charge the battery with chargers that are not approved by the manufacturer
- Do not handle a damaged or leaking Lithium Ion (Li-Ion) battery
- Do not use your device during a thunderstorm

- Never dispose of batteries or devices in a fire. Follow all local regulations when disposing of used batteries or devices.
- Never place batteries or devices on or in heating devices, such as microwave ovens, stoves, or radiators. Batteries may explode when overheated.
- Never crush or puncture the battery. Avoid exposing the battery to high external pressure, which can lead to an internal short circuit and overheating.
- Never use a damaged charger or battery
- Avoid exposing your device and batteries to very cold or very hot temperatures
- Extreme temperatures can cause the deformation of the device and reduce the charging capacity and life of your device and batteries.

- Turn off your device where prohibited
- Do not use your device near other electronic devices
- Do not use your device near a pacemaker
- Do not use your device in a hospital or near medical equipment that can be interfered with by radio frequency
- Turn off the device in potentially explosive environments
- Turn off your device when in an aircraft

- Comply with all safety warnings and regulations regarding mobile device usage while operating a vehicle
- Use a hands-free device
- Position your device within easy reach
- Let the person you are speaking with know you are driving
- Do not take notes or look up phone numbers

- Keep your device dry
- Do not use or store your device in dusty, dirty areas
- Do not store your device on slopes
- Do not store your device in hot or cold areas. Use your device at -10 °C to +55 °C

- Do not store your device with such metal objects as coins, keys and necklaces
 - Do not store your device near magnetic fields
 - Do not store your device near or in heaters, microwaves, hot cooking equipment, or high pressure containers
 - Do not drop your device or cause impacts to your device
 - Do not bite or suck on the device or the battery (childrens)
 - Protect your hearing: Excessive exposure to loud sounds can cause • hearing damage
 - Do not disassemble, modify, or repair your device
 - Do not paint your device
-
- Do not use the device for anything other than its intended use
 - Avoid disturbing others when using the device in public
 - Do not allow children to use your device
 - Install mobile devices and equipment with caution
 - Allow only qualified personnel to service your device
-
- Handle SIM cards or memory cards with care
 - Do not remove a card while the device is transferring or accessing information, as this could result in loss of data and/or damage to the card or device.
 - Protect cards from strong shocks, static electricity, and electrical noise from other devices
 - Do not touch gold-coloured contacts or terminals with your fingers or metal objects. If dirty, wipe the card with a soft cloth

When cleaning your device

- Wipe your device or charger with a towel or a rubber
- Clean the terminals of the battery with a cotton ball or a towel
- Do not use chemicals or detergents

Features

Functions:	Dual SIM Big buttons Bluetooth 3.0 Integrated camera 0,3 MP SOS button FM radio Torch Docking station MP3 player
Expansion:	MicroSD memory card
Display:	2,4" QVGA TFT LCD
System:	Mediatek MT6260A, ARM7, 64MB RAM + 64MB ROM
Network:	GSM 900/1800 (GSM/GPRS)
Size:	123 x 58 x 13 mm
Weight:	94 g
Battery:	Lithium, 1.000 mAh
Standby time:	About. 285 hours (one SIM), about. 230 hours (two SIM)
Talk time:	About. 15 hours (@-90dB 2G jel)
Power supply:	5V --- 0.6 A

* Factory data, may change

The box contains:

- WayteQ SP-1 senior phone
- Docking station
- USB cable
- Wall charger
- User manual
- Warranty card

Quality certification

We, WayteQ Europe Ltd, declare that the destination like usage of this product and according to the regulations, the product placed on the market with product marking, user manual and warranty card. Based on the declararion, published by manufacturer, CE mark of conformity is placed on the product, according to 79/1997.(XXII.31.) IKIM regulation 5.§ (1) paragraph.

Minőségtanúsítás

A forgalomba hozó tanúsítja, hogy a készülék a 2/1984. (III.10.) IpM-BkM. Sz. rendeletben előírtak szerint megfelel a leírásban szereplő műszaki jellemzőknek.

We hereby declare that all essential radio test suites have been carried out and that] the above named product is in conformity to all the essential requirements of Directive 1999/5/EC.

©2017 WayteQ Europe Kft. All Rights Reserved. The WayteQ logo is a registered trademark of WayteQ Europe Ltd.



Phone layout

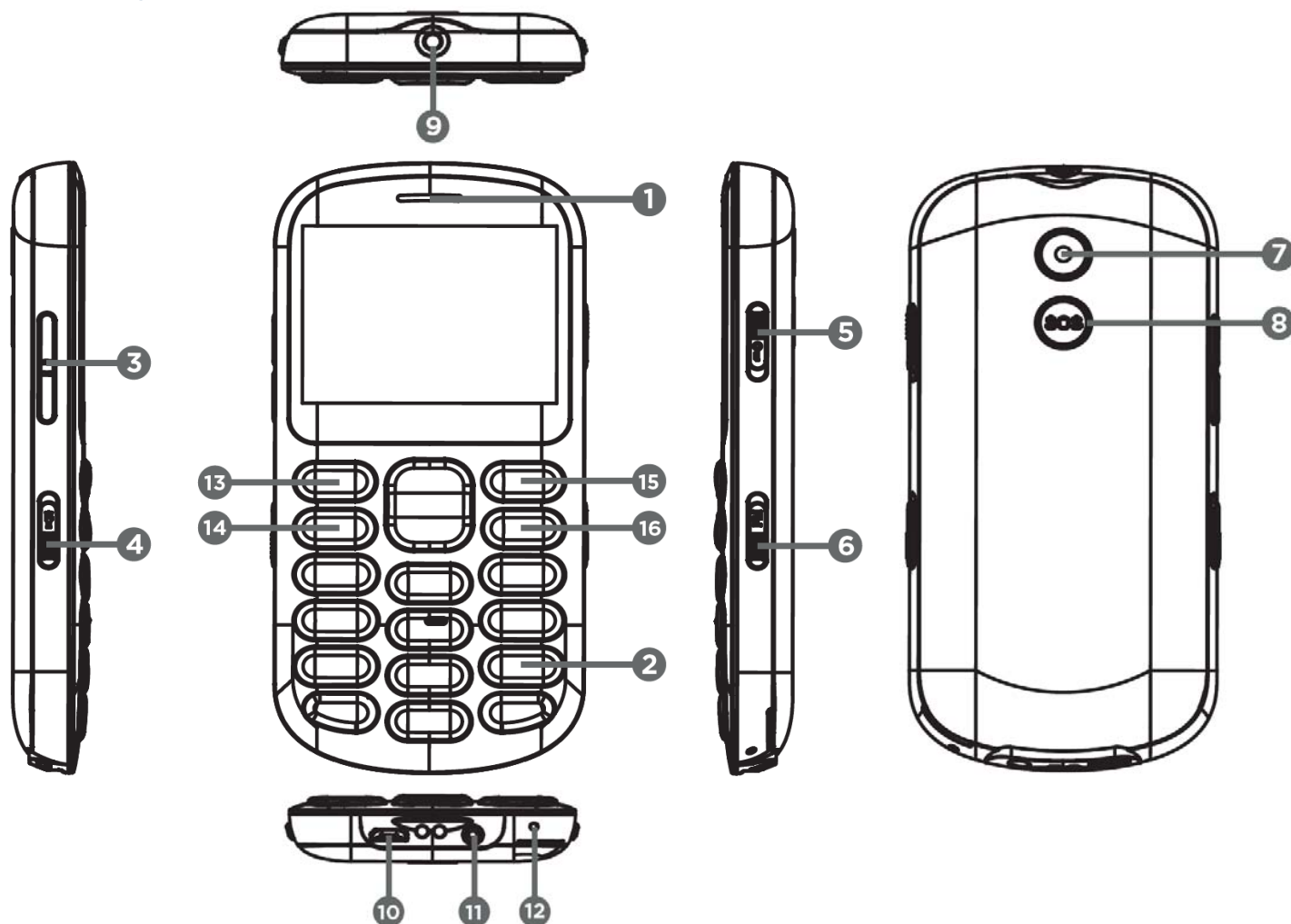

1. Speaker
2. Keyboard
3. Volume button
4. Torch button
5. Lock button
6. FM radio button
7. Camera lens
8. SOS button (in emergency)
9. LED torch
10. Micro USB plug
11. Earphone output
12. Microphone
13. Left menu button
14. Dial button
15. Right menu button
16. Power/End key

Function buttons

1. Left/Right soft key: press to perform the function currently displayed in the bottom left/right corner of the screen.
2. Dial key: answer all calls, make calls from SIM1/SIM2 card, view call logs in standby mode.
3. Navigation key: within a menu, press Up, Down, Left or Right to scroll through menu options. In standby mode, press to access main menu.
4. End/Power key
5. call or reject an incoming call, return to the standby mode. 5.*Key: press to popup the symbols screen when entering text.
6. 0 Key: press to enter Space when editing text.
7. # Key: in standby mode, Long press # key can switch between the silent mode and General mode.
8. Press to switch the input methods when entering text.

Inserting SIM cards and assembly I.

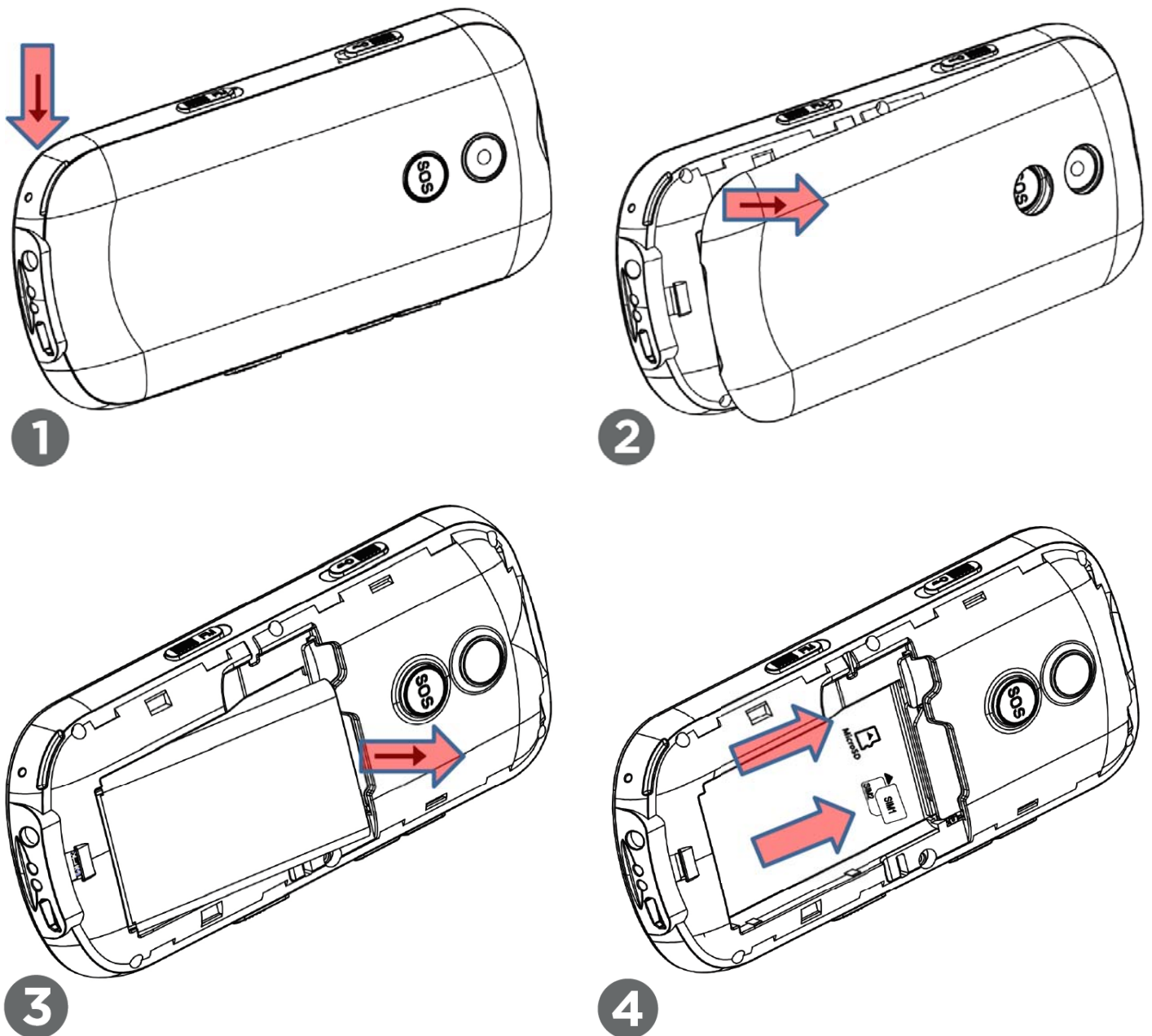

1. Turn off the device and place it faced to the ground.
2. Carefully snap off the battery cover from the bottom left corner (1), than snap off the whole battery cover (2).
3. Put off the battery (3).
4. Insert the microSD memory card (if you have) and the SIM card(s) as shown (4).
5. Place the battery and snap on the battery cover.

Inserting SIM cards and assembly II.

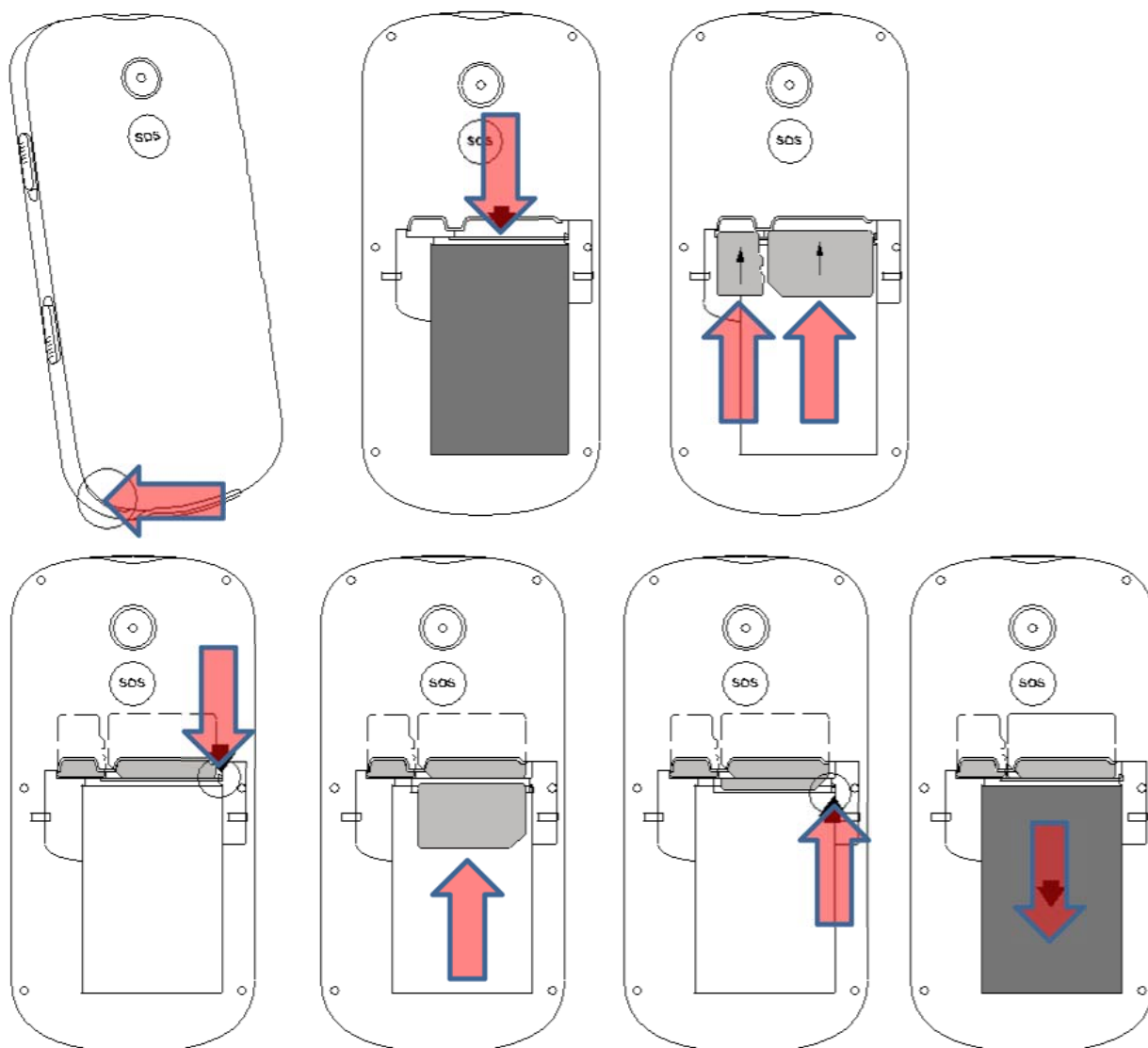

Remark:

SIM and memory cards needs to be handle very carefully.

Make sure the cards do not bend when inserted

Be sure to remove the battery before you insert the SIM card or memory card.

If it does not removed, it may cause a shortcut to cause a permanent defect in the unit!

Only MicroSIM cards are supported.

Powering the mobile phone on and off

1. Hold the „Power/End key” for 3 seconds to power the phone on. Than an animation will appear on the screen.
2. If the PIN code request appears ont he screen, than enter this 4 digit and press OK.

Language settings

1. Press the OK button.
2. With the navigatin buttons (▲▼) search for SETTING menu point, and than press OK.
3. Go to PHONE SETTINGS →LANGUAGE → SETTINGS menu.
4. Choose the desired language from the list, and than press OK.

Sharging the device

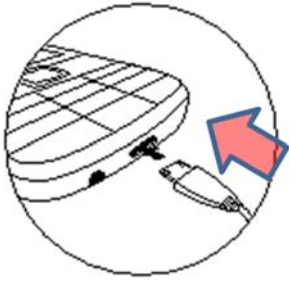

Charge with cable

Attach the enclosed USB cable to the charger or to the computer. Plug in the other plug in the device. Be careful to attach the cable in the right position.

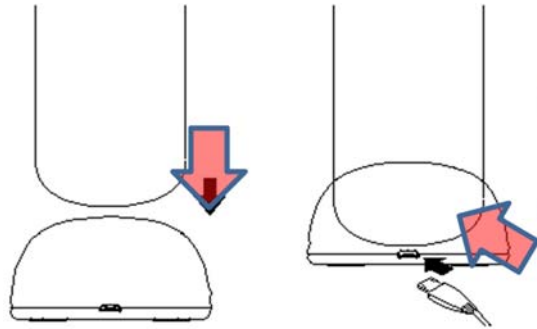

Charging with docking station

1. Attach the charging cable to the docking station's USB port.
2. Attach the charger to a wall outlet.
3. Place the phone into the cradle, be sure, that the battery cover side is faced to the cradle's usb port's side.

Remark:

It is recommended to charge the device with a dark display. The enclosed charger have 5V voltage. Do not use the device with 9V or 12V charge. Always use the enclosed charger, because the device may be defective and this is not covered by the warranty

A kijelzőn megjelenő ikonok

	Vertical bars indicate the signal strength of the GSM network signal. Five bars indicate that your current position has the best reception.		Indicates the battery charge level.
	Indicates you have one or more unread messages.		Indicates there is a missed call.
	Indicates that the alarm clock is on.		Indicates that your device is using a silent audio profile.
	Indicates that there is an attached earphone.		Indicates that the Bluetooth is on.

Importer:

WayteQ 
EUROPE

WayteQ Europe Ltd.
6th. Gubacsi str. Budapest 1097, HUNGARY
Tel: +36-1 2173-632, +36-1 2173-631
Fax: +36-1 2173-619
Web: www.wayteq.eu
Email: info@wayteq.eu